

Access

Venue: Tohoku University Seiry Campus, Sendai, Japan

2-1 Seiryomachi, Aoba, Sendai 980-8575, Japan

<https://www.med.tohoku.ac.jp/english/map/directions/index.html>

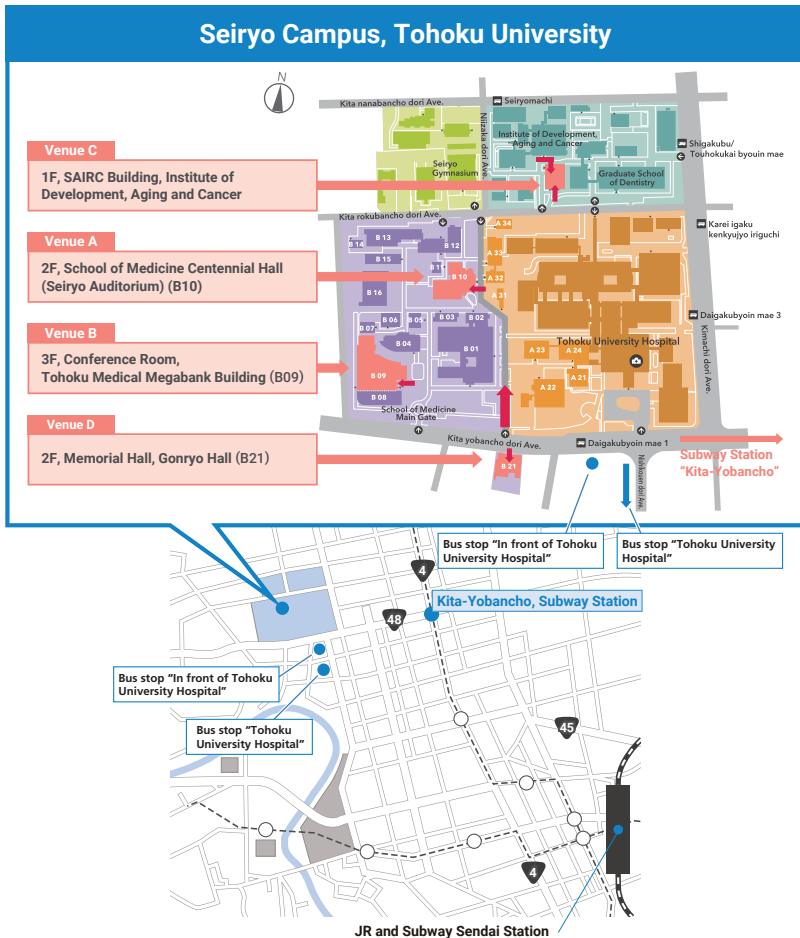

Sendai City Subway: Take a subway for "Izumi Chuo", and get off the subway at "Kitayobancho" Station.

(About 5 min from Sendai Station, ¥210). Leave "Kitayobancho" Station from the exit labelled "North 2 Exit", from which it will be a 15 min walk to Seiry campus.

Taxi: About 10 min about ¥1,300 from JR Sendai Station Taxi Pool.

Redox Week 2022

Floor Plan

Venue A: 2F, School of Medicine Centennial Hall (Seiryō Auditorium) (星陵会館 / 星陵オーデトリウム)

2-1 Seiryō-machi, Aoba-ku, Sendai, Miyagi 980-8575, Japan

1F

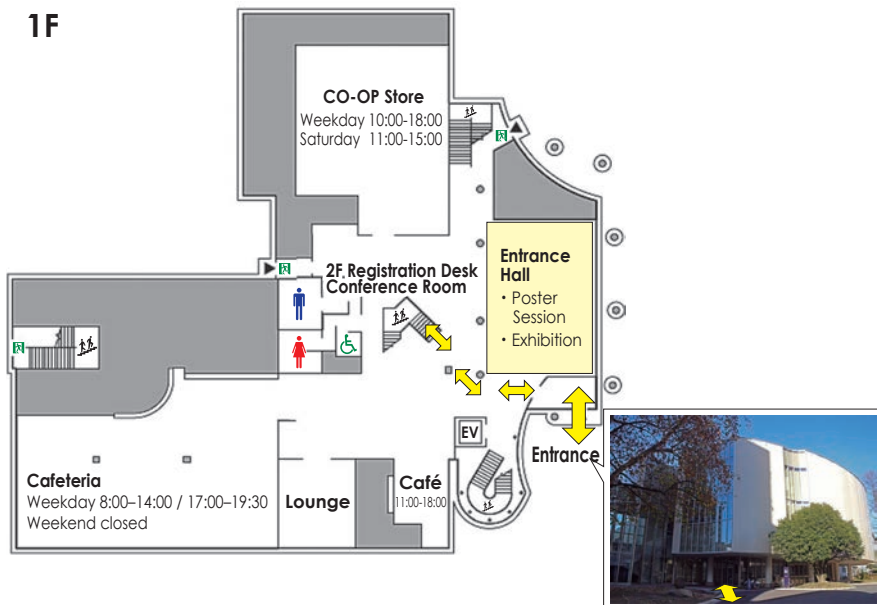

2F

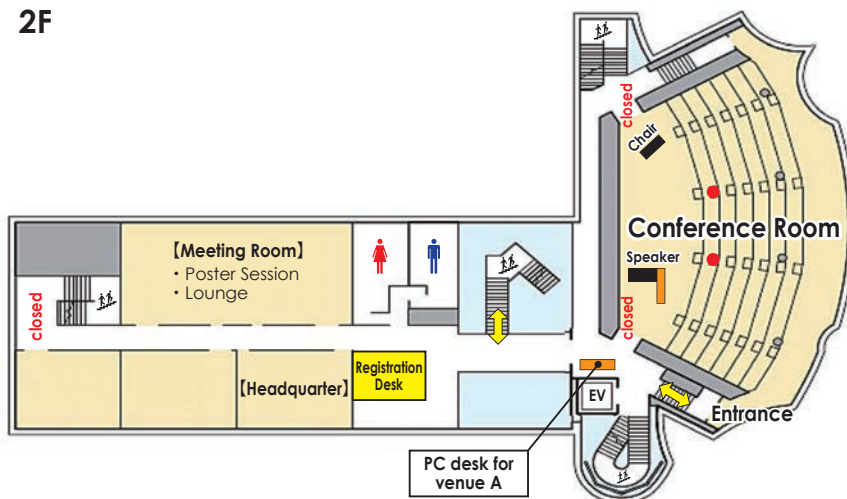

Venue B: 3F, Conference Room, Tohoku Medical Megabank Building (東北メディカル・メガバンク棟)

2-1 Seiryomachi, Aoba-ku, Sendai, Miyagi 980-8575, Japan

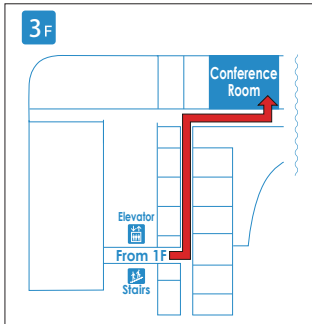
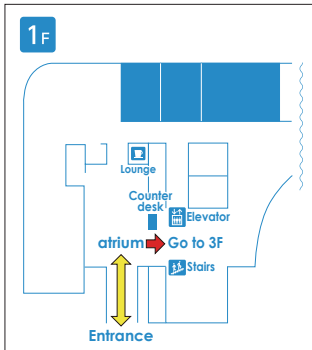
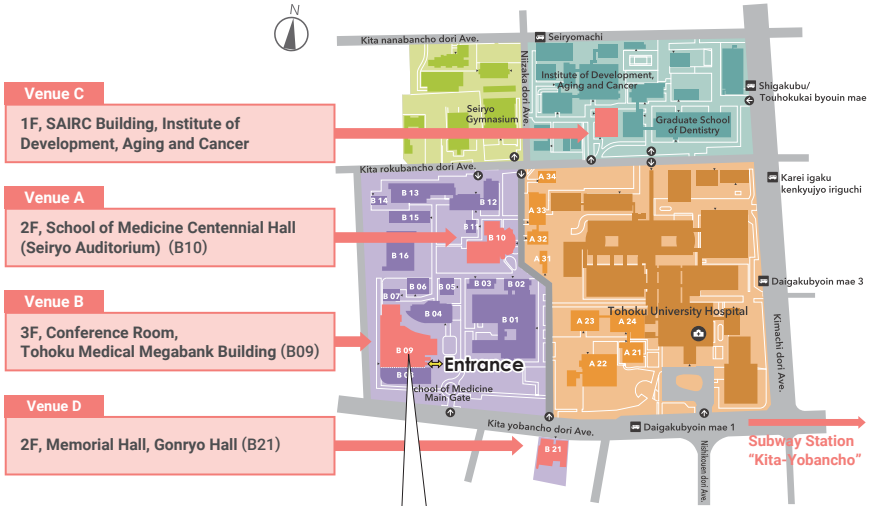

Redox Week 2022

Venue C: 1F, SAIRC Building

(スマート・エイジング研究棟)

Institute of Development, Aging and Cancer, Tohoku University
4-1 Seiryochō, Aobaku, Sendai 980-8575, Japan

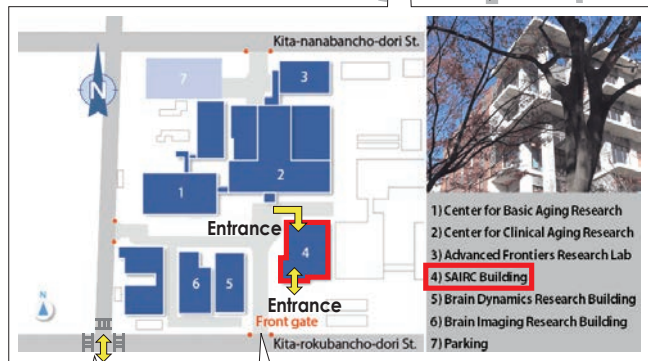
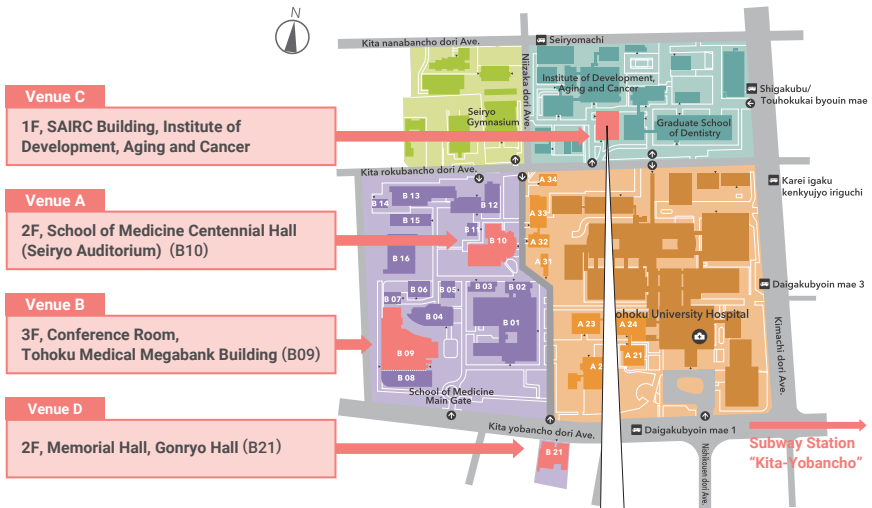

Venue A, B&D

*Please be careful when crossing the street.



Venue D: 2F, Memorial Hall, Gonryo Hall (長陵会館)

3-34 Hirose-machi, Aoba-ku, Sendai, Miyagi 980-0873, Japan

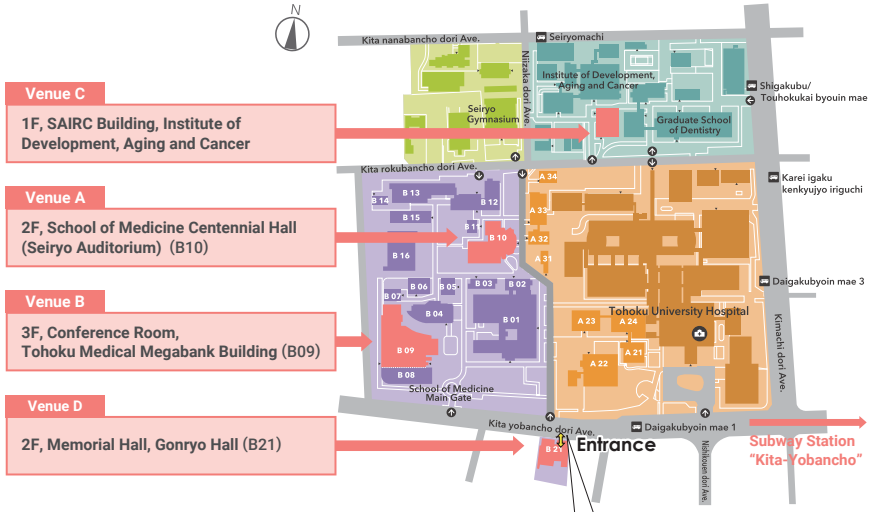

*Please be careful when crossing the street.